

CONTRACT ROUTING FORM

Contract No. _____ Project No. _____ Bid No. _____ RFP No. _____

New Contract Renewal Change Order Amendment Assignment Other

NAME OF CONTRACTOR:

CONTRACT DESCRIPTION:

CONTRACT VALUE:

GL ACCOUNT NO:

GRANT FUNDED: NO YES If YES, Grant No.

SIGNATURES RECOMMENDING APPROVAL

Conner McGowan _____ DATE 9/6/22 _____
PURCHASING/CONTRACT COORDINATOR

LEGAL DEPARTMENT DATE

DIRECTOR ADMINISTERING CONTRACT DATE
(greater than \$10,000)

APPROVED and EXECUTED

DIRECTOR ADMINISTERING CONTRACT DATE
(\$10,000 or less)

CITY MANAGER/ASST CITY MANAGER DATE
(\$50,000 or less)

MAYOR/CITY SECRETARY ATTESTS (if applicable) DATE

FINAL PROCESSING

PURCHASING DATE

for Purchasing Use Only

Insurance Certificates: Attached
Performance Bond: N/A
Payment Bond: N/A
Form 1295: 2022-928266

For City Secretary Use Only

Originals sent to CSO:
Scanned into Laserfiche/Global:
Council Date: 9/13/22 Item No.:



10535 Boyer Blvd, Austin, Texas 78664
Phone Mobile 512-786-2472
annette.thompson@convergent.com

August 25, 2022

City of Georgetown
Inner Loop Lease Space

Quotation: AT04475917P
RFP#:

Sourcewell
Contract No:

295 SE Inner loop Georgetown, Texas 78626
Attention: Trish Long

License/Cert 030421-CTL

Reference: Inner Loop Lease Space REV 07282022

On behalf of our thousands of global colleagues, I want to personally thank you for considering Convergent Technologies for this project and for providing us with the opportunity to present this proposal addressing your electronic security needs. We are confident that this proven solution is both comprehensive and customized to meet your needs today and in the years ahead.

Convergent has developed a strong reputation for service excellence and is the only company recognized twice as the Systems Integrator of the Year by SDM Magazine. Most recently, Convergent was ranked the 4th largest global systems integrator. This recognition is, in part, a reflection of the strong relationships Convergent has developed with the industry's top technology manufacturers. Convergent Technologies has a strong history of success with similar solutions provided to other clients and would be happy to provide these references upon request.

Our guiding principal has always been to be a customer-focused and service-based company, supported by dedicated and certified professionals who strive to make a daily difference. Our vision of becoming our customers' best service provider is what drives everything we do. After achieving a successful on-time and on-budget project installation, Convergent will provide you with the industry's best on-going service. This service includes our 24/7 customer portal (iCare), designed to track service work orders, project progress, and provide you with detailed metric reporting for continuous improvement.

The following security proposal is specifically designed to meet your needs. As your single point of contact, please feel free to contact me with any additional questions you may have. Thank you again for considering Convergent Technologies as your partner for your electronic security needs.

Scope of Work

Access Control – Lenel

- (1) Access Control Panel Enclosure with (1) LNL-X2220 and (4) LNL-1320's
- (1) Access Control Power Supply and Relay Enclosure
- (10) Access Control Doors; Card Reader, Door Contact, REX
- (1) Local Alarm Door; Door Contact, Local Alarm
- Composite and Misc Cabling

Video - Avigilon

- (1) Axis P3265-LVE Exterior Camera
- (2) Axis M4308-PLE Fisheye Cameras
- (4) Axis P3727-PLE Multi-Sensor Cameras and Associated Corner Mounting Hardware
- (7) ACC7 Enterprise Licenses
- Cat6 Cabling

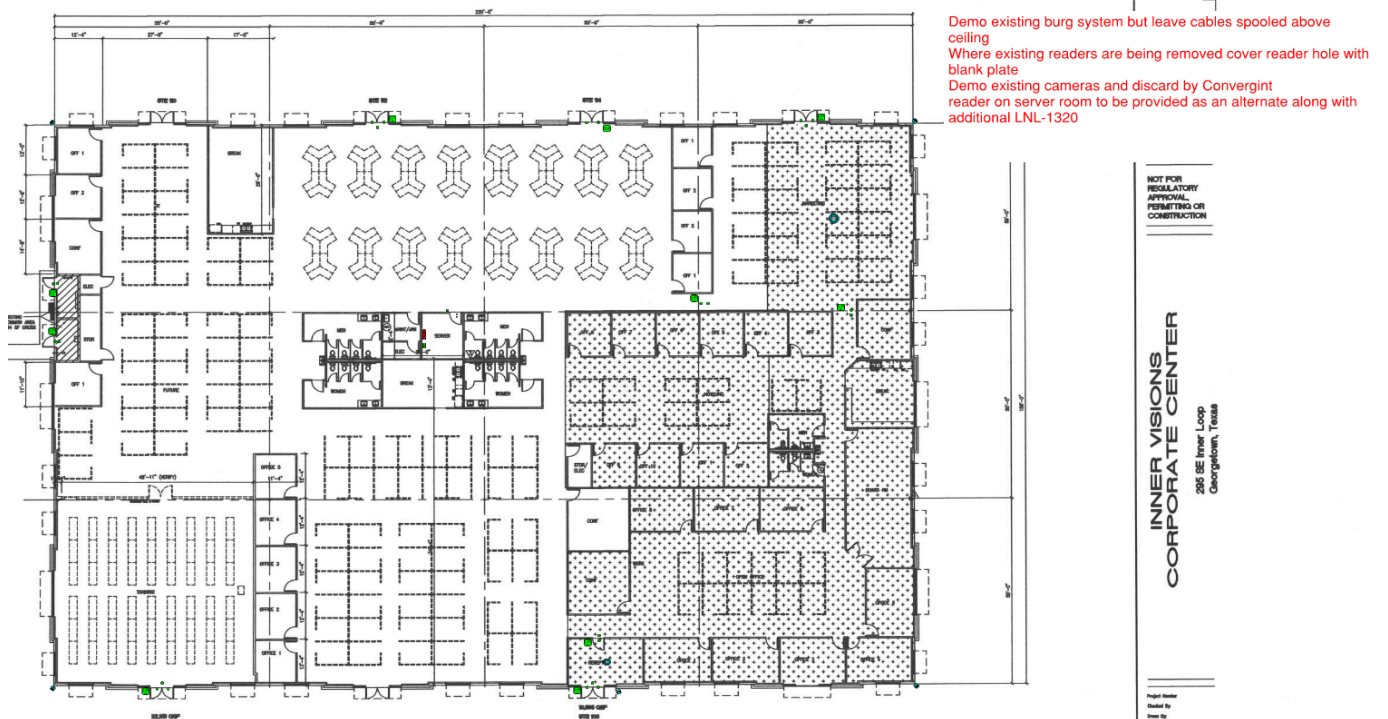

Materials

Line	Qty	Part	Description	MSRP	% Discount	Unit Price	Extended Price
1			On Sourcwell Contract No: 030421-CTL				

Line	Qty	Part	Description	MSRP	% Discount	Unit Price	Extended Price
2	1.00	LNL-X2220	Intelligent Dual Reader Controller powered by 12 or 24 VDC @ 500mA (w/o Rdr Power),, size (6 (152mm) W x 8 (203mm) L x 1 (25mm)H); 6 MB standard cardholder flash memory, 50,000 of event memory, maximum of 32 devices, On-board Ethernet, Dual Path capability, on-board two door control, OSDP Secure Channel encryption with OnGuard 7.2, Wiegand or F2F; eight inputs, four outputs, cabinet tamper and power fault input monitors. Approvals: FCC Part 15, CE, RoHS, UL 294, UL 1076, CAN/ULC 60839-11-1:2016, CSA C22.2 No. 205-1983, cUL/ORD-C1076	\$ 2,348.00	10 %	\$ 1,874.96	\$ 1,874.96
3	5.00	LNL-1320-S3	Dual Reader Interface Module (Series 3 Supports OSDP Readers) 12/24 VDC, 2 Reader interface, W/M, 8 inputs, 6 (5A) form C relays , RoHS, CE, C-Tick and UL294 certified	\$ 850.00	10 %	\$ 655.89	\$ 3,279.45
4	2.00	AX-ACM8	8 CHANNEL POWER CONTROLLER	\$ 93.97	10 %	\$ 82.89	\$ 165.78
5	2.00	AX-PD8	ALTNX PWR DIST UNT CNVRTS 1-8	\$ 43.20	10 %	\$ 34.78	\$ 69.56
6	1.00	002391-03	18-06 Unshielded Stranded Plenum Wht Jkt w/ Ylw Stripe	\$ 742.00	5 %	\$ 524.19	\$ 524.19
7	2.00	556609	23-4P Unshielded Solid Plenum Cat6 Blu Jkt	\$ 578.00	5 %	\$ 413.60	\$ 827.20
8	1.00	AX-AL1012ULB	AL1012ULXB 12VDC 10A 0 VLT DRP	\$ 252.68	5 %	\$ 243.69	\$ 243.69
9	1.00	AX-1024ULXB2	10A ACCESS 8A FIRE P/S BOARD	\$ 324.82	14%	\$ 286.26	\$ 286.26
10	1.00	AX-LPD	LOW POWER DISCONN MODULE	\$ 21.41	14%	\$ 17.98	\$ 17.98
11	7.00	ACC7-ENT	ACC 7 Enterprise camera channel	\$ 316.51	14%	\$ 266.22	\$ 1,863.54
12	1.00	AXC-02328001	AXIS P3265-LVE	\$ 749.00	10%	\$ 664.05	\$ 664.05
13	4.00	AXC-02218001	AXIS P3727-PLE	\$ 1,449.00	10 %	\$ 1,281.56	\$ 5,126.24
14	2.00	AXC-02100001	AXIS M4308-PLE Fixed Dome Camera	\$ 999.00	10 %	\$ 901.56	\$ 1,803.12
15	4.00	AXC-5507641	AXIS T91H61 WALL MOUNT	\$ 199.00	10%	\$ 165.25	\$ 661.00

Line	Qty	Part	Description	MSRP	% Discount	Unit Price	Extended Price
16	4.00	AXC-01513001	Axis T94N01D Pendant Kit	\$ 99.00	10 %	\$ 84.55	\$ 338.20
17	4.00	AXC-5017-641	AXIS T91A64 Corner Bracket	\$ 89.00	10 %	\$ 75.05	\$ 300.20
18	3.00	PW-PS1270	12V 7AH SLA BATTERY F1	\$ 27.28	4 %	\$ 14.41	\$ 43.23
19	Open Market						
20	1.00	SN-PZ1	PIEZO ON SINGLE GANG FACE PLTE	\$ 81.91	6 %	\$ 62.84	\$ 62.84
21	10.00	DS-DS160	REQUEST TO EXIT PIR - WHITE	\$ 115.88	6 %	\$ 87.12	\$ 871.20
22	2.00	4461030	4 Element Composite Cable Plenum Ylw Jkt	\$ 1,578.00	10 %	\$ 1,127.14	\$ 2,254.28
23	1.00	CON303610RC	30X36X10 N1 RC ENCLOSURE W018	\$ 713.51	6 %	\$ 662.54	\$ 662.54
24	1.00	CON242410RC	24X24X10 N1 RC ENCLOSURE W018	\$ 442.25	6 %	\$ 410.65	\$ 410.65
25	5.00	1320-SCHRG-VAR	HID Surcharge for LNL-1320-S3	\$ 0.00	10%	\$ 235.71	\$ 1,178.55
26	12.00	LV-84014040	SINGLE GANG SS BLANK FACE PLTE	\$ 10.64	5 %	\$ 7.80	\$ 93.60
27	21.00	GI-6644	RESISTOR PK W/1K RESISTOR	\$ 5.52	5 %	\$ 4.15	\$ 87.15
28	16.00	GI-18012W	3/4 REC STL DR LEAD 1/2 WHT	\$ 7.12	5 %	\$ 5.35	\$ 85.60
29	10.00	8212ABT0000	uTrust TS Keypad Government Reader Terminal - Wiegand	\$ 807.69	30%	\$ 432.14	\$ 4,321.40
30	10.00	Reader-Surcharge	Temporary reader surcharge for access control readers	\$ 0.00	30%	\$ 50.00	\$ 500.00
31	4.00	H2-CMSJHK55	J-HOOK 4 25 PACK	\$ 151.98	5 %	\$ 114.27	\$ 457.08
32	17.00	H2-CMSJHK44	2 J-HOOKS - 25 PACK	\$ 89.28	5 %	\$ 67.12	\$ 1,141.04
33	2.00	0E-C6BL36	3FT CAT6 PATCH CABLE BLUE 6PK	\$ 20.06	5 %	\$ 14.70	\$ 29.40
34	Labor on Sourcewell Contract No: 030421-CTL						

Equipment Total	\$30,243.98
Total Labor/Other Costs	\$27,119.28
Tax if Applicable	\$0.00
Total Project Price	\$57,363.26

Clarifications and Exclusion

1. All work proposed herein, shall be performed during normal business hours Monday through Friday 8:00 am - 5:00 pm.
2. Low voltage wiring shall be installed via open air code approved methods.
3. Provision or installation of conduit, wire, boxes, fittings or other electrical installation materials unless specifically listed under Inclusions or Bill of Materials.
4. Permits or associated fees are not included.
5. Customer to provide static IP addresses and network connections at panel locations.
6. Customer to provide a secured staging & storage area for project related materials.
7. Pricing assumes that electronic Auto CAD files are available from customer for our use in creating submittal drawings.
8. Twenty-Five percent (25%) of the proposed sell price shall be payable to Convergent Technologies for project mobilization. Mobilization shall be invoiced and due upon customer acceptance of this proposal.
9. Proposal does not include sales tax unless otherwise noted.
10. Anything in the Contract Documents notwithstanding, in no event shall either Contractor or Subcontractor be liable for special, indirect, incidental or consequential damages, including commercial loss, loss of use, or lost profits, even if either party has been advised of the possibility of such damages.
11. Convergent Technologies reserves the right to negotiate mutually acceptable contract terms and conditions with customer by making mutually agreeable changes to the formal contract included in the Bid Documents.

PERFORMANCE MATRIX

YES	NO	PERFORMANCE ITEM	PERFORMANCE ITEM	YES	NO
<input type="checkbox"/>	<input type="checkbox"/>	Material (as shown in the BOM below)	Mounting of Proposed Devices	<input checked="" type="checkbox"/>	<input type="checkbox"/>
<input type="checkbox"/>	<input checked="" type="checkbox"/>	Applicable Tax	Network Video Recorder (NVR)	<input type="checkbox"/>	<input checked="" type="checkbox"/>
<input type="checkbox"/>	<input checked="" type="checkbox"/>	FA Permit and Plan Review Fee	Installation of NVR	<input type="checkbox"/>	<input checked="" type="checkbox"/>
<input checked="" type="checkbox"/>	<input type="checkbox"/>	Freight (Prepaid)	Terminal Cabinets	<input type="checkbox"/>	<input checked="" type="checkbox"/>
<input type="checkbox"/>	<input checked="" type="checkbox"/>	Payment Bond	Installation of Terminal Cabinets	<input type="checkbox"/>	<input checked="" type="checkbox"/>
<input type="checkbox"/>	<input checked="" type="checkbox"/>	Performance Bond	Specialty Backboxes	<input type="checkbox"/>	<input checked="" type="checkbox"/>
<input type="checkbox"/>	<input checked="" type="checkbox"/>	System Meets Contract Drawings	Installation of Specialty Backboxes	<input type="checkbox"/>	<input checked="" type="checkbox"/>
<input checked="" type="checkbox"/>	<input type="checkbox"/>	System is Design-Build	Electrified Locking Hardware	<input type="checkbox"/>	<input checked="" type="checkbox"/>
<input type="checkbox"/>	<input checked="" type="checkbox"/>	Attend GC Project Meetings	Installation of Locking Hardware	<input type="checkbox"/>	<input checked="" type="checkbox"/>
<input checked="" type="checkbox"/>	<input type="checkbox"/>	Attend Owner Project Meetings	Termination of Cable at Hinge	<input checked="" type="checkbox"/>	<input type="checkbox"/>
<input type="checkbox"/>	<input checked="" type="checkbox"/>	Ceiling Tile/Grid Repair	Door/Frame Preparation	<input checked="" type="checkbox"/>	<input type="checkbox"/>
<input type="checkbox"/>	<input checked="" type="checkbox"/>	Electrical Installation Permit	Power to Electrified Locking Hardware	<input checked="" type="checkbox"/>	<input type="checkbox"/>
<input type="checkbox"/>	<input checked="" type="checkbox"/>	Horizontal Core Drilling	Cabling through Door to Electrified Handset	<input type="checkbox"/>	<input checked="" type="checkbox"/>
<input type="checkbox"/>	<input checked="" type="checkbox"/>	Vertical Core Drilling	Installation of IP Cameras	<input checked="" type="checkbox"/>	<input type="checkbox"/>
<input type="checkbox"/>	<input checked="" type="checkbox"/>	120 VAC Power	Installation of Cabling to IP Intercom	<input type="checkbox"/>	<input checked="" type="checkbox"/>
<input type="checkbox"/>	<input checked="" type="checkbox"/>	Installation of Conduit	Installation of Cabling to IP Cameras	<input checked="" type="checkbox"/>	<input type="checkbox"/>
<input type="checkbox"/>	<input checked="" type="checkbox"/>	Installation of Backboxes	Installation of Cabling to Card Reader	<input checked="" type="checkbox"/>	<input type="checkbox"/>
<input checked="" type="checkbox"/>	<input type="checkbox"/>	Firestopping	Installation of Bridal Rings/J-Hooks	<input checked="" type="checkbox"/>	<input type="checkbox"/>
<input type="checkbox"/>	<input checked="" type="checkbox"/>	Correction of Faults Caused by Others	Installation of Control Panels	<input checked="" type="checkbox"/>	<input type="checkbox"/>
<input type="checkbox"/>	<input checked="" type="checkbox"/>	O&M Manuals	Servers by Convergent	<input type="checkbox"/>	<input checked="" type="checkbox"/>
<input checked="" type="checkbox"/>	<input type="checkbox"/>	Submittal Drawings	Servers by Others	<input checked="" type="checkbox"/>	<input type="checkbox"/>
<input type="checkbox"/>	<input checked="" type="checkbox"/>	Record Drawings (As-Built)/Leander to supply drawings	Workstations by Convergent	<input type="checkbox"/>	<input checked="" type="checkbox"/>
<input type="checkbox"/>	<input checked="" type="checkbox"/>	Panel Wall/Rack Elevation Drawings	Workstations by Others	<input checked="" type="checkbox"/>	<input type="checkbox"/>
<input type="checkbox"/>	<input checked="" type="checkbox"/>	Panel Wiring Point-to-Point Details	Loading Software on Workstation	<input checked="" type="checkbox"/>	<input type="checkbox"/>
<input type="checkbox"/>	<input checked="" type="checkbox"/>	Door Wiring Details	Patch Panel	<input type="checkbox"/>	<input checked="" type="checkbox"/>
<input checked="" type="checkbox"/>	<input type="checkbox"/>	Floorplan with Device Placement/Leander to supply plans	Installation of Patch Panel	<input type="checkbox"/>	<input checked="" type="checkbox"/>
<input checked="" type="checkbox"/>	<input type="checkbox"/>	One-Year Warranty on Parts	Patch Cables	<input type="checkbox"/>	<input checked="" type="checkbox"/>
<input checked="" type="checkbox"/>	<input type="checkbox"/>	One-Year Warranty on Labor	Installation of Patch Cables	<input type="checkbox"/>	<input checked="" type="checkbox"/>
<input checked="" type="checkbox"/>	<input type="checkbox"/>	One-Year Software Support	Owner to Provide Static IP Addresses	<input checked="" type="checkbox"/>	<input type="checkbox"/>
<input type="checkbox"/>	<input checked="" type="checkbox"/>	One-Year Monitoring	Fire Watch	<input type="checkbox"/>	<input checked="" type="checkbox"/>
<input type="checkbox"/>	<input checked="" type="checkbox"/>	On-Site Lockable Storage	System Programming	<input checked="" type="checkbox"/>	<input type="checkbox"/>
<input type="checkbox"/>	<input checked="" type="checkbox"/>	Lifts	Testing of All Proposed Devices	<input checked="" type="checkbox"/>	<input type="checkbox"/>
<input type="checkbox"/>	<input checked="" type="checkbox"/>	Floor Coverings for Lifts	Network cabling/connection between buildings	<input type="checkbox"/>	<input checked="" type="checkbox"/>
<input type="checkbox"/>	<input checked="" type="checkbox"/>	Patch-and-Paint	Conduit	<input type="checkbox"/>	<input checked="" type="checkbox"/>
<input type="checkbox"/>	<input checked="" type="checkbox"/>	120VAC, conduit, door pathways, backboxes etc.	Electrified locking hardware to be repurposed from existing doors	<input type="checkbox"/>	<input checked="" type="checkbox"/>
<input type="checkbox"/>	<input type="checkbox"/>	Remove existing readers and cameras: Plate and spool old cable up if not reused		<input type="checkbox"/>	<input type="checkbox"/>

Total Project Investment:

\$ 57,363.26

Thank you for considering Convergent Technologies for your Security needs. If you have any questions or would like additional information, please don't hesitate to contact me immediately.

Sincerely,

Annette Thompson

Convergent Technologies

Annette Thompson

Trish Long

Customer Name (Printed)

August 25, 2022

Date

CONTRACTOR

By: _____

Printed Name: _____

Title: _____

Date: _____

CITY OF GEORGETOWN

By: _____

Josh Schroeder, Mayor

Date: _____

ATTEST:

Robyn Densmore, City Secretary

APPROVED AS TO FORM:

Skye Masson, City Attorney

CERTIFICATE OF INTERESTED PARTIES

FORM 1295

1 of 1

Complete Nos. 1 - 4 and 6 if there are interested parties.
 Complete Nos. 1, 2, 3, 5, and 6 if there are no interested parties.

**OFFICE USE ONLY
 CERTIFICATION OF FILING**

Certificate Number:
 2022-928266

Date Filed:
 08/30/2022

Date Acknowledged:

1 Name of business entity filing form, and the city, state and country of the business entity's place of business.

Convergent Technologies
 Austin, TX United States

2 Name of governmental entity or state agency that is a party to the contract for which the form is being filed.

City of Georgetown

3 Provide the identification number used by the governmental entity or state agency to track or identify the contract, and provide a description of the services, goods, or other property to be provided under the contract.

22-0122-GC
 Installation of Video System and Access Control

4	Name of Interested Party	City, State, Country (place of business)	Nature of interest (check applicable)	
			Controlling	Intermediary

5 Check only if there is NO Interested Party.

6 UNSWORN DECLARATION

My name is Annette Thompson, and my date of birth is 9/19/66.

My address is 10535 Boyer Blvd, Austin, TX, 78758, Travis.
(street) (city) (state) (zip code) (country)

I declare under penalty of perjury that the foregoing is true and correct.

Executed in Travis County, State of TX, on the 2 day of Sept, 2022.
(month) (year)

 Signature of authorized agent of contracting business entity
 (Declarant)



CERTIFICATE OF LIABILITY INSURANCE

DATE (MM/DD/YYYY)
02/25/2022

THIS CERTIFICATE IS ISSUED AS A MATTER OF INFORMATION ONLY AND CONFERS NO RIGHTS UPON THE CERTIFICATE HOLDER. THIS CERTIFICATE DOES NOT AFFIRMATIVELY OR NEGATIVELY AMEND, EXTEND OR ALTER THE COVERAGE AFFORDED BY THE POLICIES BELOW. THIS CERTIFICATE OF INSURANCE DOES NOT CONSTITUTE A CONTRACT BETWEEN THE ISSUING INSURER(S), AUTHORIZED REPRESENTATIVE OR PRODUCER, AND THE CERTIFICATE HOLDER.

IMPORTANT: If the certificate holder is an ADDITIONAL INSURED, the policy(ies) must have ADDITIONAL INSURED provisions or be endorsed. If SUBROGATION IS WAIVED, subject to the terms and conditions of the policy, certain policies may require an endorsement. A statement on this certificate does not confer rights to the certificate holder in lieu of such endorsement(s).

PRODUCER Willis Towers Watson Midwest, Inc. c/o 26 Century Blvd P.O. Box 305191 Nashville, TN 372305191 USA	CONTACT NAME: Willis Towers Watson Certificate Center PHONE (A/C. No. Ext): 1-877-945-7378 FAX (A/C. No): 1-888-467-2378 E-MAIL ADDRESS: certificates@willis.com
INSURER(S) AFFORDING COVERAGE	
INSURED Convergent Technologies LLC #204 Location #204 One Commerce Drive Schaumburg, IL 60173	INSURER A: XL Insurance America Inc NAIC # 24554 INSURER B: Federal Insurance Company 20281 INSURER C: XL Specialty Insurance Company 37885 INSURER D: INSURER E: INSURER F:

COVERAGES **CERTIFICATE NUMBER: W24016452** **REVISION NUMBER:**

THIS IS TO CERTIFY THAT THE POLICIES OF INSURANCE LISTED BELOW HAVE BEEN ISSUED TO THE INSURED NAMED ABOVE FOR THE POLICY PERIOD INDICATED. NOTWITHSTANDING ANY REQUIREMENT, TERM OR CONDITION OF ANY CONTRACT OR OTHER DOCUMENT WITH RESPECT TO WHICH THIS CERTIFICATE MAY BE ISSUED OR MAY PERTAIN, THE INSURANCE AFFORDED BY THE POLICIES DESCRIBED HEREIN IS SUBJECT TO ALL THE TERMS, EXCLUSIONS AND CONDITIONS OF SUCH POLICIES. LIMITS SHOWN MAY HAVE BEEN REDUCED BY PAID CLAIMS.

INSR LTR	TYPE OF INSURANCE	ADDL INSD	SUBR WVD	POLICY NUMBER	POLICY EFF (MM/DD/YYYY)	POLICY EXP (MM/DD/YYYY)	LIMITS
A	<input checked="" type="checkbox"/> COMMERCIAL GENERAL LIABILITY <input type="checkbox"/> CLAIMS-MADE <input checked="" type="checkbox"/> OCCUR GEN'L AGGREGATE LIMIT APPLIES PER: <input type="checkbox"/> POLICY <input checked="" type="checkbox"/> PRO-JECT <input checked="" type="checkbox"/> LOC OTHER:			CGD 7422095	03/01/2022	03/01/2023	EACH OCCURRENCE \$ 1,000,000 DAMAGE TO RENTED PREMISES (Ea occurrence) \$ 300,000 MED EXP (Any one person) \$ 10,000 PERSONAL & ADV INJURY \$ 1,000,000 GENERAL AGGREGATE \$ 2,000,000 PRODUCTS - COMP/OP AGG \$ 2,000,000
A	AUTOMOBILE LIABILITY <input checked="" type="checkbox"/> ANY AUTO <input type="checkbox"/> OWNED AUTOS ONLY <input type="checkbox"/> SCHEDULED AUTOS <input type="checkbox"/> HIRED AUTOS ONLY <input type="checkbox"/> NON-OWNED AUTOS ONLY			CAD 7459994 01	03/01/2022	03/01/2023	COMBINED SINGLE LIMIT (Ea accident) \$ 1,000,000 BODILY INJURY (Per person) \$ BODILY INJURY (Per accident) \$ PROPERTY DAMAGE (Per accident) \$
B	<input type="checkbox"/> UMBRELLA LIAB <input checked="" type="checkbox"/> OCCUR <input checked="" type="checkbox"/> EXCESS LIAB <input type="checkbox"/> CLAIMS-MADE			9365-2578	03/01/2022	03/01/2023	EACH OCCURRENCE \$ 10,000,000 AGGREGATE \$ 10,000,000
C	WORKERS COMPENSATION AND EMPLOYERS' LIABILITY ANY PROPRIETOR/PARTNER/EXECUTIVE OFFICER/MEMBER EXCLUDED? (Mandatory in NH) If yes, describe under DESCRIPTION OF OPERATIONS below	Y/N No	N/A	CWD 7459993 01	03/01/2022	03/01/2023	<input checked="" type="checkbox"/> PER STATUTE <input type="checkbox"/> OTH-ER E.L. EACH ACCIDENT \$ 1,000,000 E.L. DISEASE - EA EMPLOYEE \$ 1,000,000 E.L. DISEASE - POLICY LIMIT \$ 1,000,000
C	Workers Compensation - WI and Employers Liability Per Statute			CWR 7459998 01	03/01/2022	03/01/2023	EL Each Accident \$1,000,000 EL Disease-Each Empl. \$1,000,000 EL Disease-Policy Lmt \$1,000,000

DESCRIPTION OF OPERATIONS / LOCATIONS / VEHICLES (ACORD 101, Additional Remarks Schedule, may be attached if more space is required)
 Master Agreement 204

CERTIFICATE HOLDER City of Georgetown	CANCELLATION SHOULD ANY OF THE ABOVE DESCRIBED POLICIES BE CANCELLED BEFORE THE EXPIRATION DATE THEREOF, NOTICE WILL BE DELIVERED IN ACCORDANCE WITH THE POLICY PROVISIONS. AUTHORIZED REPRESENTATIVE
---	--